

Rigging screw for lashing "Hamburgher" - art. 6330

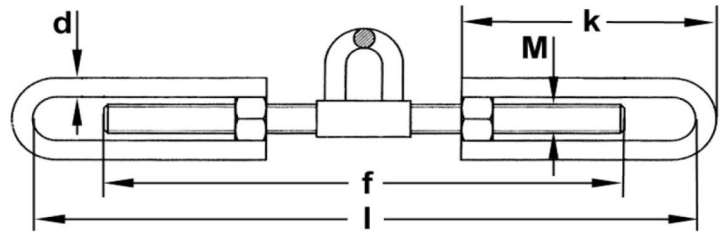

* Reference norm	Industrial standard
* Type of steel	Low carbon steel
* Design factor (F.O.S.)	Determined by user
* Standard surface finish	Self-coloured
* Applications	Lashing of loads on board of ships
* Remarks	Use for lifting forbidden!



Technical data									
code	size M	length f	BREAKING load - t ⁽¹⁾	measures mm				approx. weight per pc. kg	
				approximate length l		diameter d	length k		
				closed	open				
FVTER2440	24	400	13	468	720	16	210	3	
FVTER2740	27	400	18	464	710	18	210	4,4	
FVTER3040	30	400	20	460	700	20	210	5	

⁽¹⁾ metric tons of 1.000 kgs

The sizes in bold character are stock-items.

Galvanized rigging screw for rescue boats - art. 6350

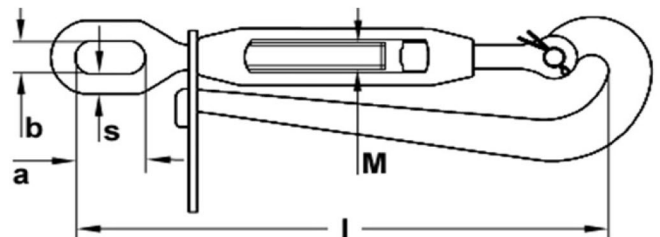

* Reference norm	Industrial standard
* Type of steel	Low carbon steel
* Design factor (F.O.S.)	5 : 1
* Standard surface finish	Electro galvanized
* Applications	Lashing of rescue boats on board of ships
* Remarks	Use for lifting forbidden!



Technical data								
code	M	WLL t ⁽¹⁾	measures mm				approx. weight per pc. kg	
			approximate length l		depth a	width b		diameter s
			closed	open				
FVTEL0024	24	2,5	435	545	58	30	20	4,45

⁽¹⁾ metric tons of 1.000 kgs

The sizes in bold character are stock-items.