

Choker hook for steel wire rope standard type - art. 3500

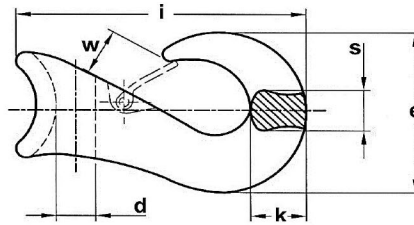

* Reference standard	Industrial standard
* Type of steel	39NiCrMo3 steel quenched and tempered, class 8
* Design factor (F.O.S.)	5 : 1
* Standard surface finish	Red RAL 3001 painted, safety latch kit electro galvanised
* Technical features	High capacity compared to dimensions
* Applications	Component of choker lifting sling, mainly in construction industry
* Warnings	This hook should be used only in choker sling; other uses may cause dangerous situations - never use hooks without safety latch or with a damaged safety latch - please refer to the technical part of fittings section for deepening and other warnings

Dimensional tolerances

The dimensional tolerances for forged pieces according to norm UNI EN 10243-1 apply

Technical data

code	nominal size inch	rope dia. mm	WLL t *	measures mm						weight per pc. appr. kg
				dia. d	width w	length i	height e	thickness s	thickness k	
VSGSCS013	3/8 - 1/2	10 - 13	1,6	17	25	127	67	17	23	0,60
VSGSCS016	5/8	14 - 16	2	22	28	148	79	18	28	0,90
VSGSCS020	3/4	18 - 20	3	27	36	170	100	23	34	1,70
VSGSCS026	7/8 - 1	22 - 26	5	33	47	209	133	34	41	3,50
VSGSCS040	1.5/8	28 - 40	10	45	50	255	150	39	45	6,50

* metric tons of 1.000 kgs

The sizes in bold character are stock-items.

Choker hook for steel wire rope Choker type - art. 3600



* Reference standard	Industrial standard
* Type of steel	39NiCrMo3 steel quenched and tempered or the like, class 8
* Design factor (F.O.S.)	5 : 1
* Standard surface finish	Red RAL 3001 painted
* Technical features	High capacity compared to dimensions
* Applications	Component of choker lifting sling, in forestry field
* Warnings	This hook should be used only in choker sling; different uses may cause dangerous situations - please refer to the technical part of fittings section for deepening and other warnings

Dimensional tolerances

The dimensional tolerances for forged pieces according to norm UNI EN 10243-1 apply

Technical data

code	nominal size inch	rope dia. mm	model	WLL t *	measures mm					weight per pc. appr. kg
					rope hole	overall length	max. height	ferrule hole	thickness	
VSGSCH011	5/16-7/16	8 - 11	Micro	2,5	16	90	51,5	17	35	0,36
VSGSCH013	3/8 - 1/2	10 - 13	Midget	3,5	17	94	46	17,5	36	0,37

* metric tons of 1.000 kgs

The sizes in bold character are stock-items.