

## Eyenuit with elongated eye to UNI 2948 ISO metric thread coarse - art. 2948

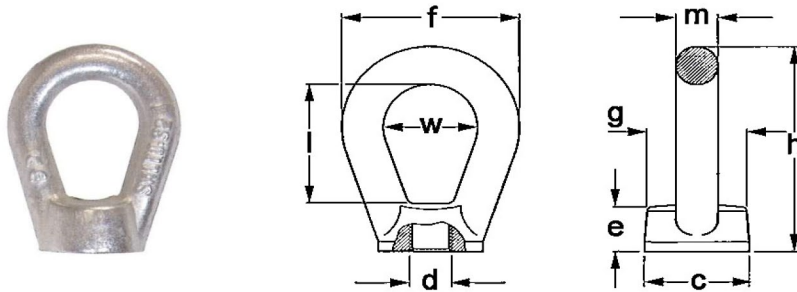

* Reference standard	UNI 2948
* Type of steel	S275JR steel (former Fe430b) - class 4
* Design factor (F.O.S.)	4 : 1
* Standard finish	Self-coloured (ungalvanized); electro galvanized upon request
* Applications	Lifting and suspending of loads in industry and marine
* Warnings	Working temperature -20° +200° C - please refer to the technical part of attachment section for deepening and other warnings

### Dimensional tolerances

inside width of eye  $w \pm 1$  mm

inside height of eye  $i \pm 1,5$  mm

### Technical data

self-coloured code	electro-galvanized code	WLL <sup>(1)</sup>		measures mm										approx. kg per pc.
		along the axe	at 45° <sup>(2)</sup>	filetto		width	height	dia.	dia.	thickness		height	width	
				dia. d	pitch	w	l	c	g	e	m	h	f	
GLFEMOA08	GLFEMAZ08	0,08	0,04	8	1,25	18	26	24	19	10	8	43,5	34	0,07
GLFEMOA10	GLFEMAZ10	0,16	0,08	10	1,5	24	34	30	28	14	10	58	44	0,14
GLFEMOA12	GLFEMAZ12	0,25	0,125	12	1,75	30	43	34	32	16	13	72	56	0,26
GLFEMOA14	GLFEMAZ14	0,32	0,16	14	2	30	43	34	32	16	13	72	56	0,26
GLFEMOA16	GLFEMAZ16	0,4	0,2	16	2	36	50	40	38	20	16	86	68	0,43
GLFEMOA18	GLFEMAZ18	0,51	0,255	18	2,5	36	50	40	38	20	16	86	68	0,41
GLFEMOA20	GLFEMAZ20	0,63	0,315	20	2,5	42	57	48	45	24	19	100	80	0,59
GLFEMOA22	GLFEMAZ22	0,8	0,4	22	2,5	42	57	48	45	24	19	100	80	0,70
GLFEMOA24	GLFEMAZ24	1	0,5	24	3	50	69	56	53	28	22	119	94	1,09
GLFEMOA27	GLFEMAZ27	1,25	0,625	27	3	50	69	56	53	28	22	119	94	1,04
GLFEMOA30	GLFEMAZ30	1,6	0,8	30	3,5	60	79	68	64	36	26	141	112	1,83
GLFEMOA36	GLFEMAZ36	2,5	1,25	36	4	70	93	80	75	42	29	164	128	2,79
GLFEMOA42	GLFEMAZ42	3,75	1,875	42	4,5	82	109	92	87	50	33	192	148	4,32
GLFEMOA48	GLFEMAZ48	5	2,5	48	5	90	117	105	99	58	36	211	162	6,02

<sup>(1)</sup> metric tons of 1.000 kg

The sizes in bold character are stock-items.

<sup>(2)</sup> maximum side load. **WARNING: side load is permitted only along the eye's plan**