

Oversized high tensile shackle galvanized

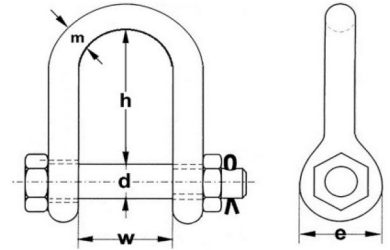
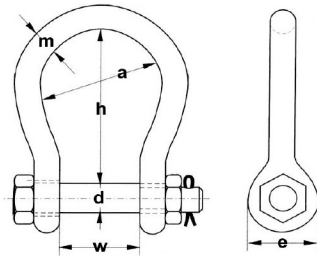

safety pin bow - art. 2130 B L

safety pin dee - art. 2150 BL

* Reference standard	Industrial standard, generally complying to norm EN 13889
* Type of steel	High tensile steel heattreated, class 6
* Design factor (F.O.S.)	6 : 1 (bow), 5 : 1 (dee)
* Standard surface finish	Hot dip galva, pin electro galvanized and painted
* Technical features	Inside dimensions much larger than standard high tensile shackles of corresponding WLL
* Applications	Lifting, suspension and towing of loads in industry and marine, when shackles featuring higher inside dimensions than standard high tensile shackles are requested
* Warnings	The given WLL refers to pull along the shackle's axe; side loads decrease the WLL significantly - working temperature -50° to +200° C - please refer to the technical part of shackle section for deepening and other warnings

Dimensional tolerances

diameter of body m	da 4,6 to 9,5 t		12 t and larger
	+/- 2,5 mm		+/- 3 mm
diameter of pin d	+/- 2 mm		
minimum width w	da 4,6 to 6,5 t	da 9,5 to 30 t	55 t and larger
	+/- 1,5 mm	+/- 3,5 mm	+/- 6,5 mm
height h	+/- 6,5 mm		

Technical features

bow type art. 2130 BL		dee type art. 2150 BL		nominal size inch	measures mm					approx. weight per pc kg	
code	WLL t ⁽¹⁾	code	WLL t ⁽¹⁾		pin d	body m	opening w	opening a	height h		width e
-	-	GG215W046	4,6	3/4	22	19	70	-	116	46	1,5
GG213W047	4,75	-	-	7/8	25	22	63	88	112	52	2,08
GG213W065	6,5	-	-	1	28	25	75	105	135	59	3,14
-	-	GG215W086	8,6	1	28	25	83	-	140	59	3,15
GG213W085	8,5	-	-	1.1/8	32	28	82	115	148	66	4,36
GG213W095	9,5	-	-	1.1/4	35	32	90	126	162	72	5,95
GG213W120	12	-	-	1.3/8	38	35	100	140	180	79	7,87
-	-	GG215W155	15,5	1.1/2	42	38	115	-	178	88	9,5
GG213W160	16	-	-	1.1/2	42	38	106	159	216	89	12,5
GG213W250	25	-	-	1.3/4	50	45	127	175	248	104	18
GG213W300	30	-	-	2	57	50	146	207	273	111	25
GG213W550	55	-	-	2.1/2	70	65	165	213	314	145	48
GG213W750	75	-	-	3	83	75	184	254	330	163	70

⁽¹⁾ metric tons of 1.000 kgs

The sizes in bold character are stock items.